

ASSEMBLY INSTRUCTIONS

COHERE FLIP & NEST TABLE

NOTE:

PLEASE COUNT AND INSPECT ALL PIECES BEFORE DISPOSING OF ANY CARTON OR PACKING MATERIALS.

When ordering components, specific color and/or size information may be required.
Contact a Mayline Customer Service Representative. 1-800-822-8037

COMPONENTS

REF#	QTY.	DESCRIPTION	PART NO.	
1	1	Top	CALL ~**	
2	1	Mech/Handle Assy	CALL~~	** Denotes Color Code
3	1	Leg Assembly	CALL ~**	~~Denotes Size

HARDWARE BAG (Part No. DS111)

REF#	QTY.	DESCRIPTION
E1	20	Screw, #12 x 1" PHS
E2	8	Screw, 1/4-20 x 1/2" PHS
E3	6	Cable Clip & Screw, #6 x 1/2" PHS

Replacement Parts not included in assembly

REF#	QTY.	DESCRIPTION	PART NO.
R1	1	Caster Standard	DS108
R2	1	Caster Premium	DS109
R3	1	Pull Handle, Yoke	DS469

Recommended tools for Assembly:

#3 Phillips bit for larger screws.
#2 Phillips bit for smaller screws.

1. Place Top (1) face down on a clean flat surface. Attach Mech/Handle Assembly (2) onto Top using 12 Screws (E1). **

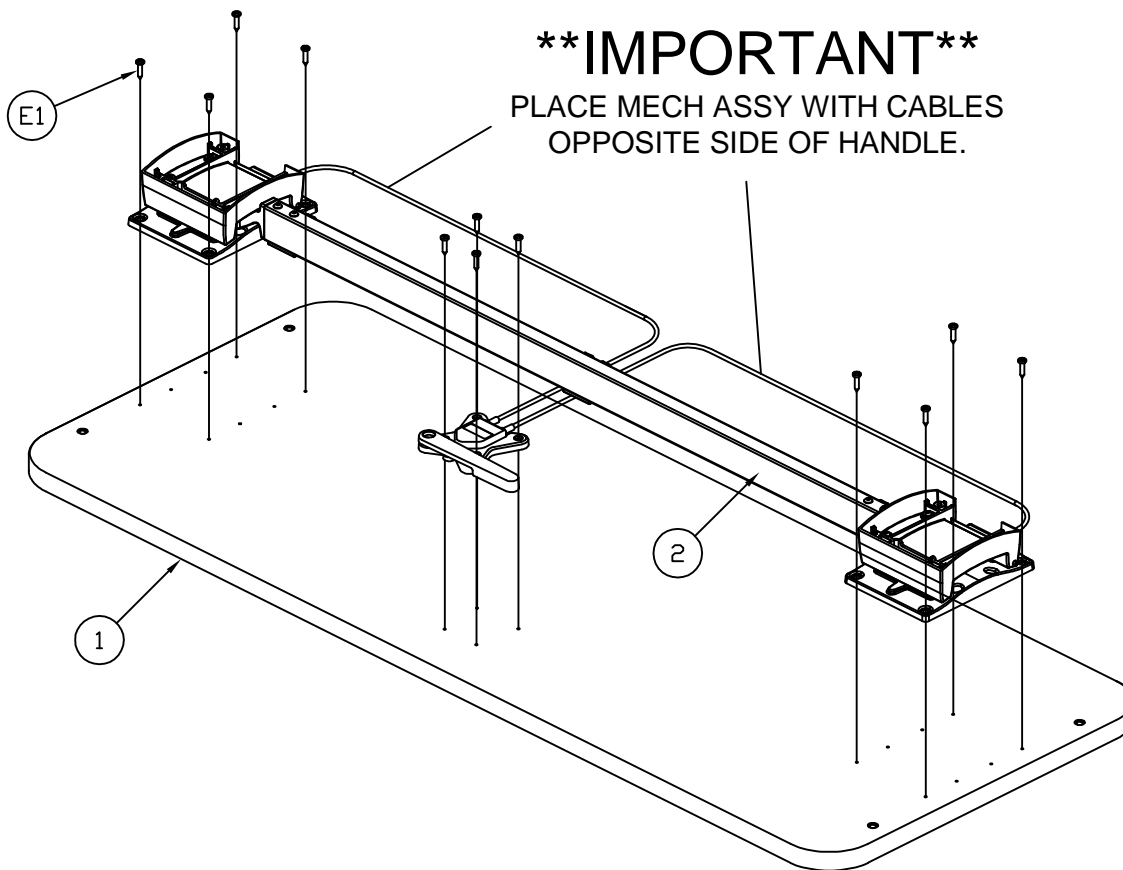

****IMPORTANT****

PLACE MECH ASSY WITH CABLES
OPPOSITE SIDE OF HANDLE.

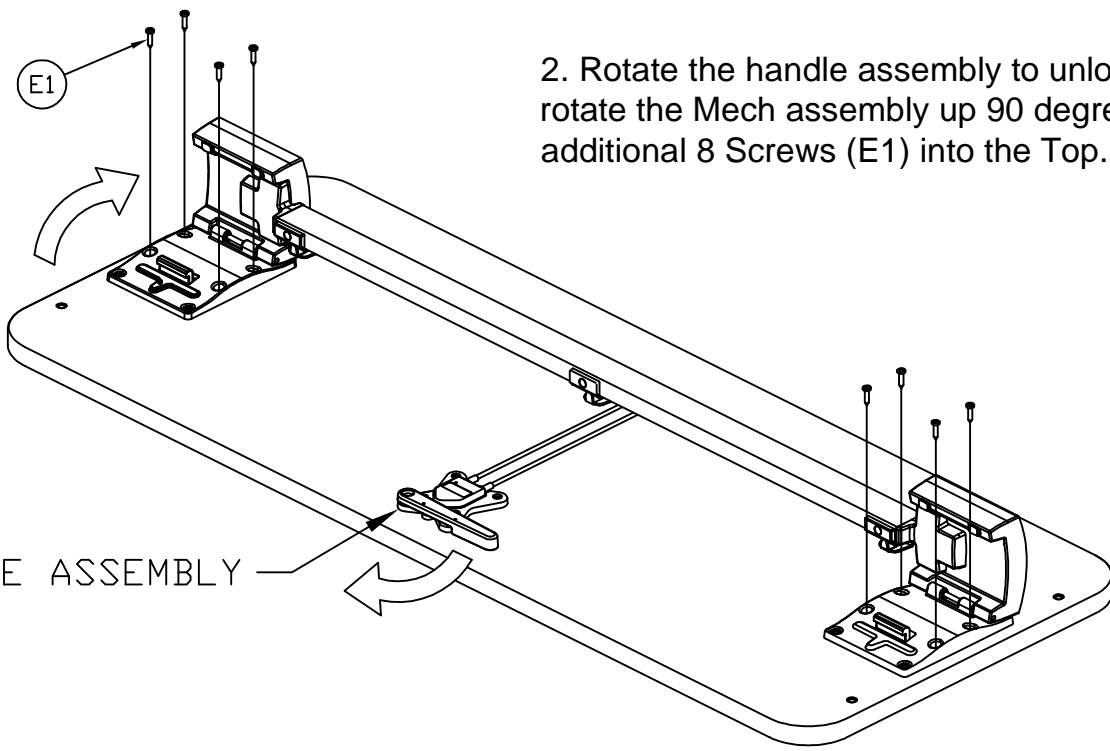

2. Rotate the handle assembly to unlock, then rotate the Mech assembly up 90 degrees. Attach additional 8 Screws (E1) into the Top.

HANDLE ASSEMBLY

3. Attach Leg Assembly (3) onto the Mech Assembly using 8 Screws (E2).

4. Layout cable on one side similar as shown below and attach 2 or 3 Cable Clips (E3) to Top using Screw (E3). **For the best appearance mirror Cable Clips & Screws on other side.**

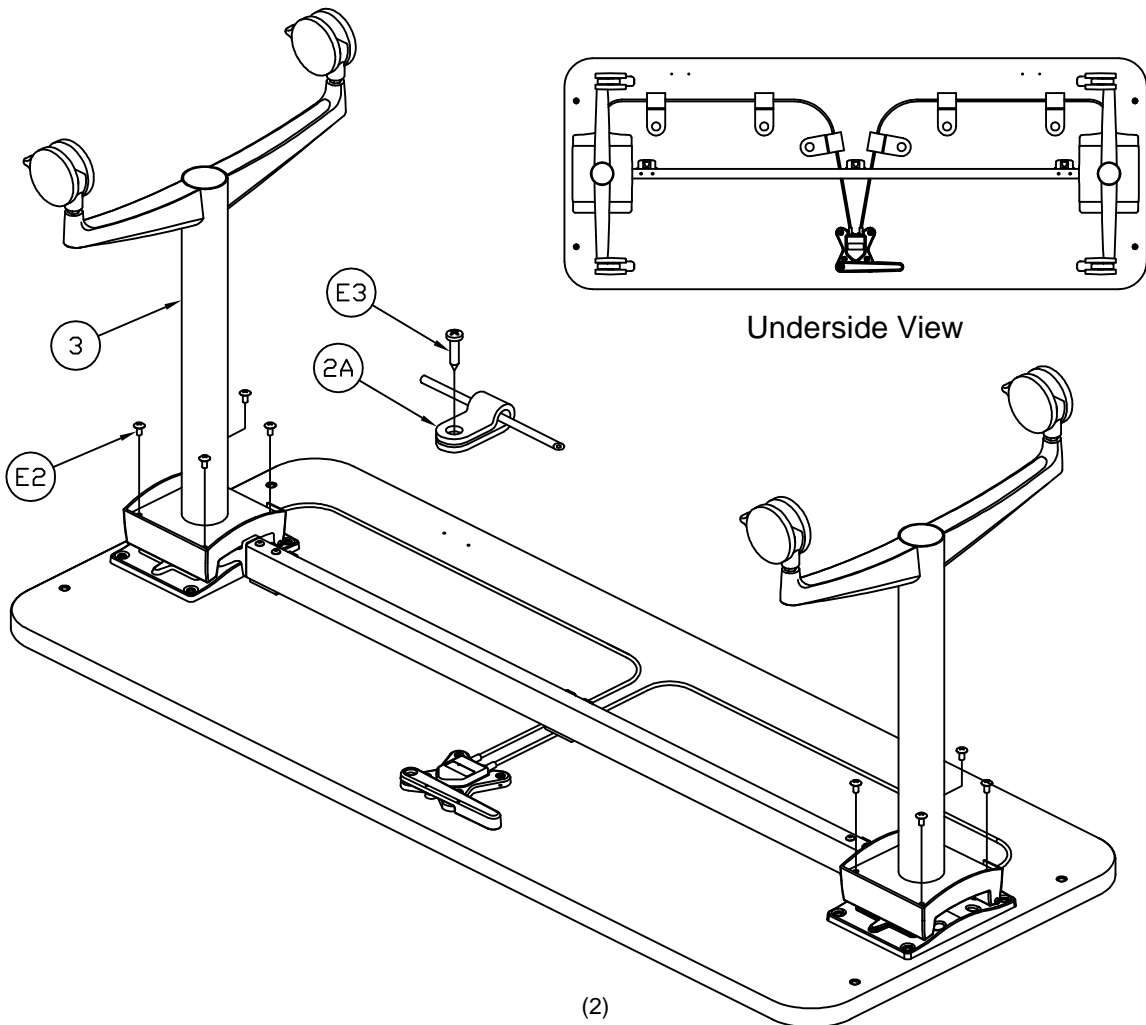

Underside View

OPERATING INSTRUCTIONS

1. Rotate Top Up - Rotate handle to unlock and lift table top up 90 degrees.
2. Rotate Top Down - Rotate handle to unlock and lower table top down 90 degrees.

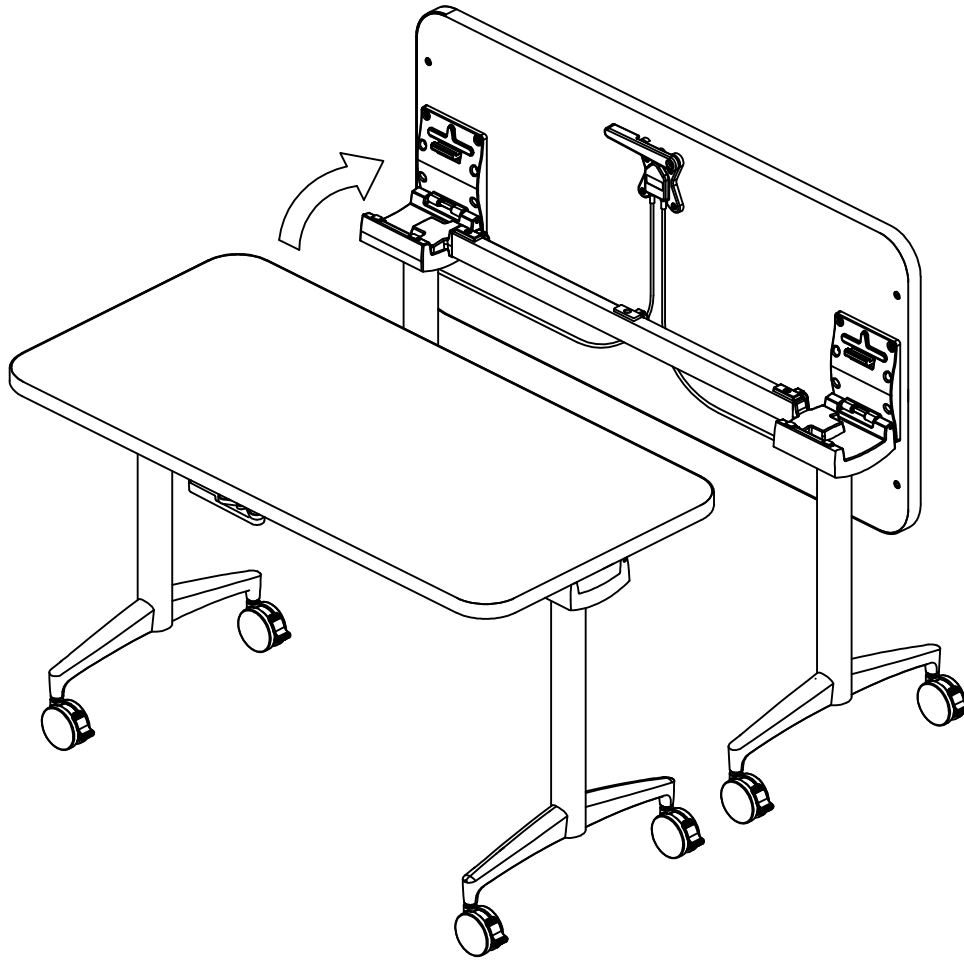

Replacement Parts not included in assembly

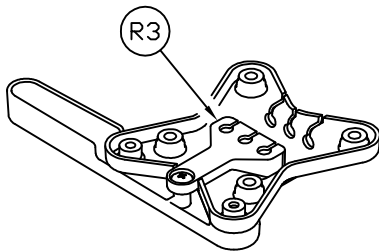

Extra inserts on the underside of the top are for optional ganging kit 10GA & Pie connectors.

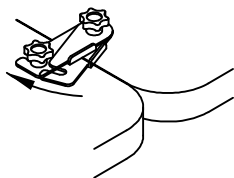

10GA Ganging Kit

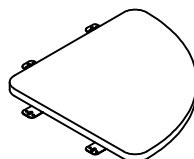

90°
Pie Connector

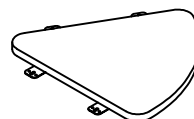

45°
Pie Connector



30°
Pie Connector